



EnerRocket™
CONTINUOUSLY SAFEGUARDING

ES 7-12

SMF VRLA RECHARGEABLE BATTERY

**LONG
LIFE
SERIES**

APPLICATIONS

- UPS Systems
- Telecommunication Systems
- Fire Alarm Safety & Security Systems
- Medical Equipment

COMPLIANCE STANDARDS

IEC 60896 PART 21 & 22
BS6290-4

TECHNICAL FEATURES



- Non-Spillable Sealed Construction
- Seal Lead Acid Battery
- Absorbent Glass Mat System (AGM System)
- ABS (Acrylonitrile Butadiene Styrene) construction (FR optional)
- Gas Recombination
- Venting System for low internal pressure
- Low Self-Discharge
- Heavy-Duty, Highly Optimized Grids
- High Power Output
- Wide Operating Temperature
- Maintenance-Free Operation

CHARACTERISTICS

Nominal Voltage	12 V	
Design Life	10 Years	
Capacity 27°C (80.6°F)	20 Hour rate	7Ah
	10 Hour rate	6.7Ah
	5 Hour rate	5.6Ah
Internal Resistance (25°C, 100% Charge)	25mΩ	
Self Discharge (20°C)	1 Month	Remaining Capacity 97%
Operating Temperature	Discharge	-20°C - 60°C
	Charge	-10°C - 60°C
	Storage	-20°C - 60°C
Normal Operating Temperature	25°C ± 3°C	
Maximum Discharge current	105A (5sec)	
Maximum Charging current	2.88A	
Short Circuit Current	350A	
Charge Methods	14.4 to 14.7 V	
Constant Voltage Charge 77°F (25°C) - Cycle use	Temp. Compensation -30mV/°C	
Charge methods	13.4 to 13.8V	
Constant Voltage Charge 77°F (25°C) - Standby Use	Temp. Compensation -20mV/°C	

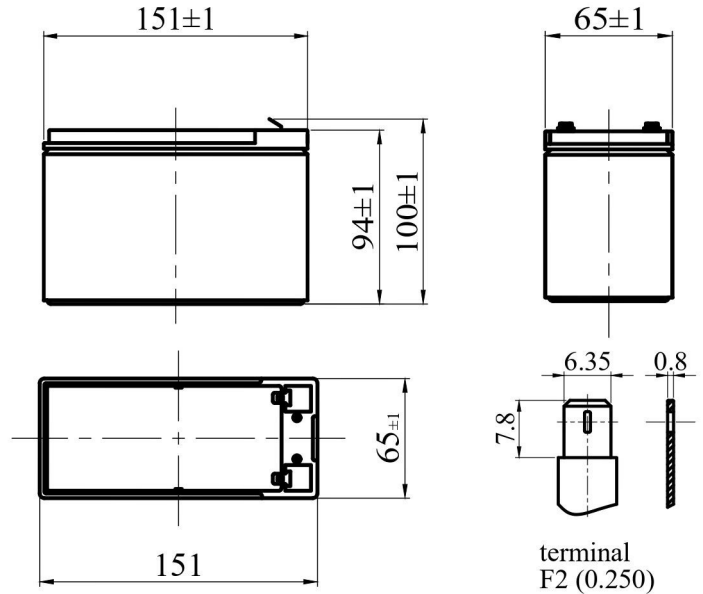

SPECIFICATIONS

Length	Width	Height	Total Height	Weight (kg)
151 mm	65 mm	94 mm	100 mm	2.2 ± 5%

CONSTANT CURRENT DISCHARGE (Amperes) AT 25°C

End Voltage Volts/Cell	5min	10min	15min	30min	1h	3h	5h	10h	20h
1.60	30.0	18.8	15.3	8.50	4.80	1.88	1.25	0.66	0.38
1.65	28.4	17.9	14.6	8.15	4.63	1.82	1.20	0.65	0.38
1.70	26.8	17.0	13.9	7.86	4.44	1.76	1.16	0.64	0.37
1.75	25.2	16.0	13.2	7.56	4.25	1.69	1.12	0.63	0.36
1.80	23.5	15.1	12.5	7.18	4.04	1.64	1.10	0.60	0.35

CONSTANT POWER DISCHARGE (Watts) AT 25°C

End Voltage Volts/Cell	5min	10min	15min	30min	1h	3h	5h	10h	20h
1.60	53.3	35.8	28.1	15.50	9.30	3.68	2.38	1.34	0.70
1.65	50.7	34.0	27.0	14.90	8.90	3.59	2.34	1.32	0.69
1.70	48.1	32.2	25.9	14.30	8.53	3.49	2.30	1.30	0.68
1.75	45.6	30.4	24.8	13.70	8.28	3.38	2.25	1.28	0.66
1.80	43.1	28.6	23.8	13.20	7.90	3.27	2.19	1.26	0.64



ES 7-12

SMF VRLA RECHARGEABLE BATTERY

**LONG
LIFE
SERIES**

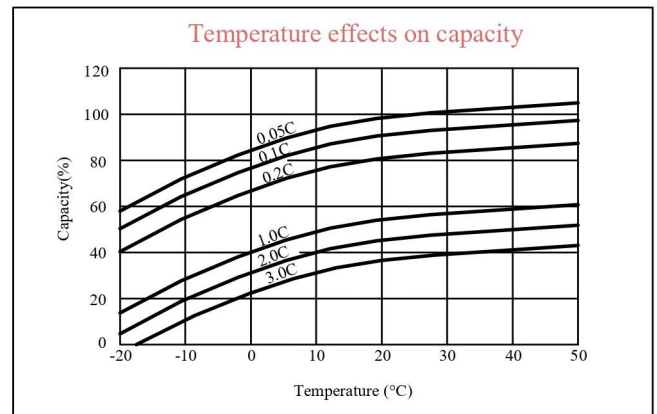
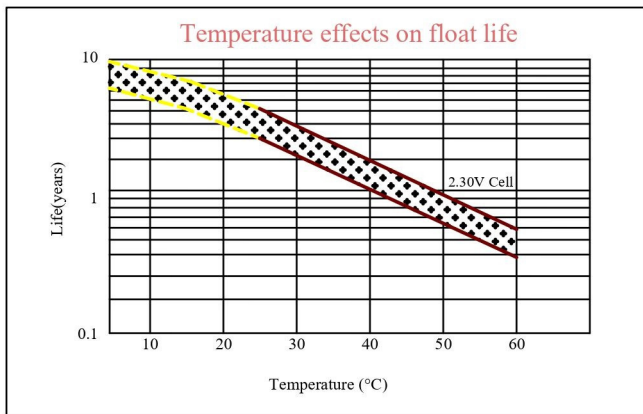
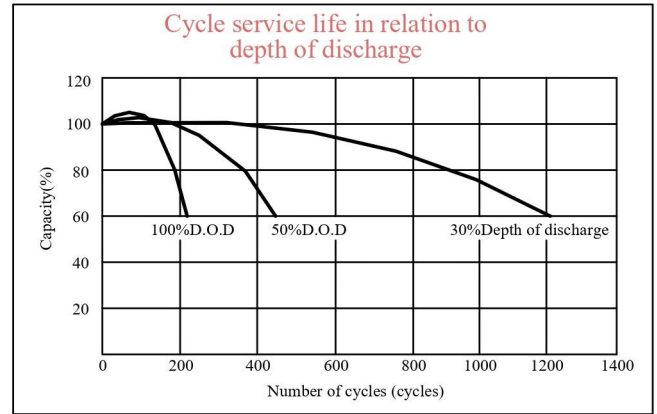
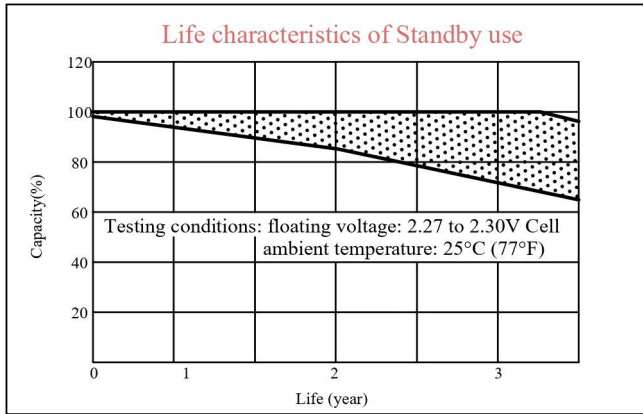
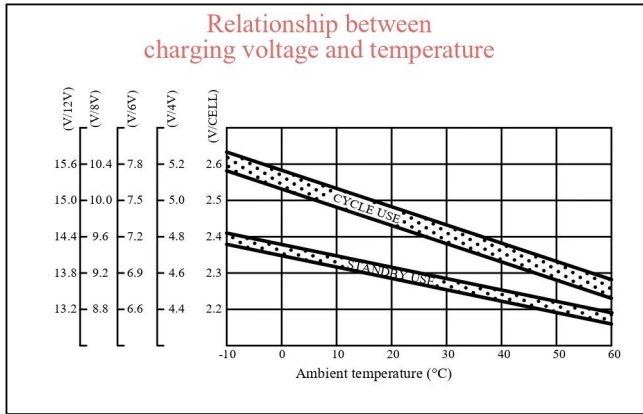
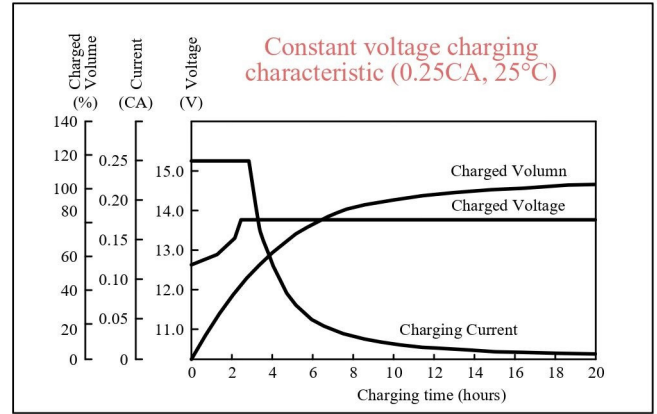
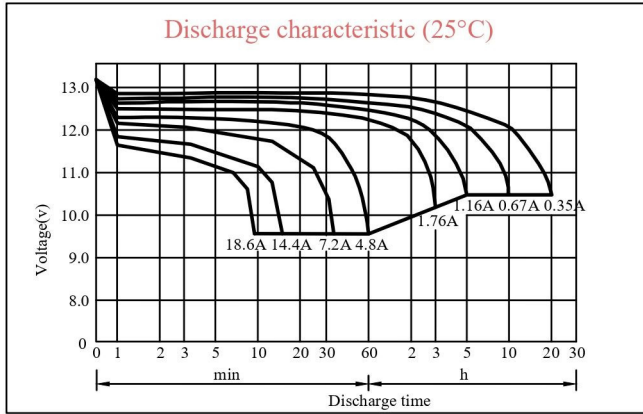

v205.2